

Shipping Containers for an Affordable Future

WORKING TOGETHER TO
CREATE AFFORDABLE HOUSING
TO ADDRESS URGENT NEEDS

Giant

Giant Containers

Giant Containers is a global supplier of prefabricated shipping container structures. Giant provides creative and innovative enclosure solutions to a wide range of industries with industry leading customer service, cutting edge ideas and quality materials.

From the very beginning, our mission was to deliver eco-friendly, affordable, custom enclosures — cost-effective sustainable structures in a timely fashion. From build to build we consistently noted the cost and time efficiencies, the low impact on the surrounding communities (noise, dust, pollution) and the reduction of waste overall vs. traditional builds. It became very clear how container housing could be a major solution to the housing crisis and the challenges governments face when looking for supportive housing solutions. We reached out to a number of developers, government bodies and not-for-profit organizations with our ideas and our desire to make a difference. As a result of this outreach, we've had the opportunity to work with the UN and the Red Cross and are currently working with 5 North American cities on supportive housing solutions - some that we'll see come to fruition as early as 2020 in the US. Each of these projects are a minimum 4 stories and contain over 200+ shipping container modules.

We push the limits of what can be achieved with a great idea and a shipping container.



Affordable Housing

Reducing Construction Costs

While manufacturing and other industries have raised productivity steadily in the past few decades, in construction it has remained flat or gone down in many countries. Likewise, in many places residential housing is still built in the same way it was 50 years ago. Project costs could be reduced by about 30 percent and completion schedules shortened by about 40 percent if developers make use of value engineering (standardizing design) and industrial approaches, such as assembling buildings from prefabricated components manufactured off-site. Efficient procurement methods and other process improvements would help, as well.



30%

“Access to decent, affordable housing is the foundation for families and households across the world.”

UN Global Compact

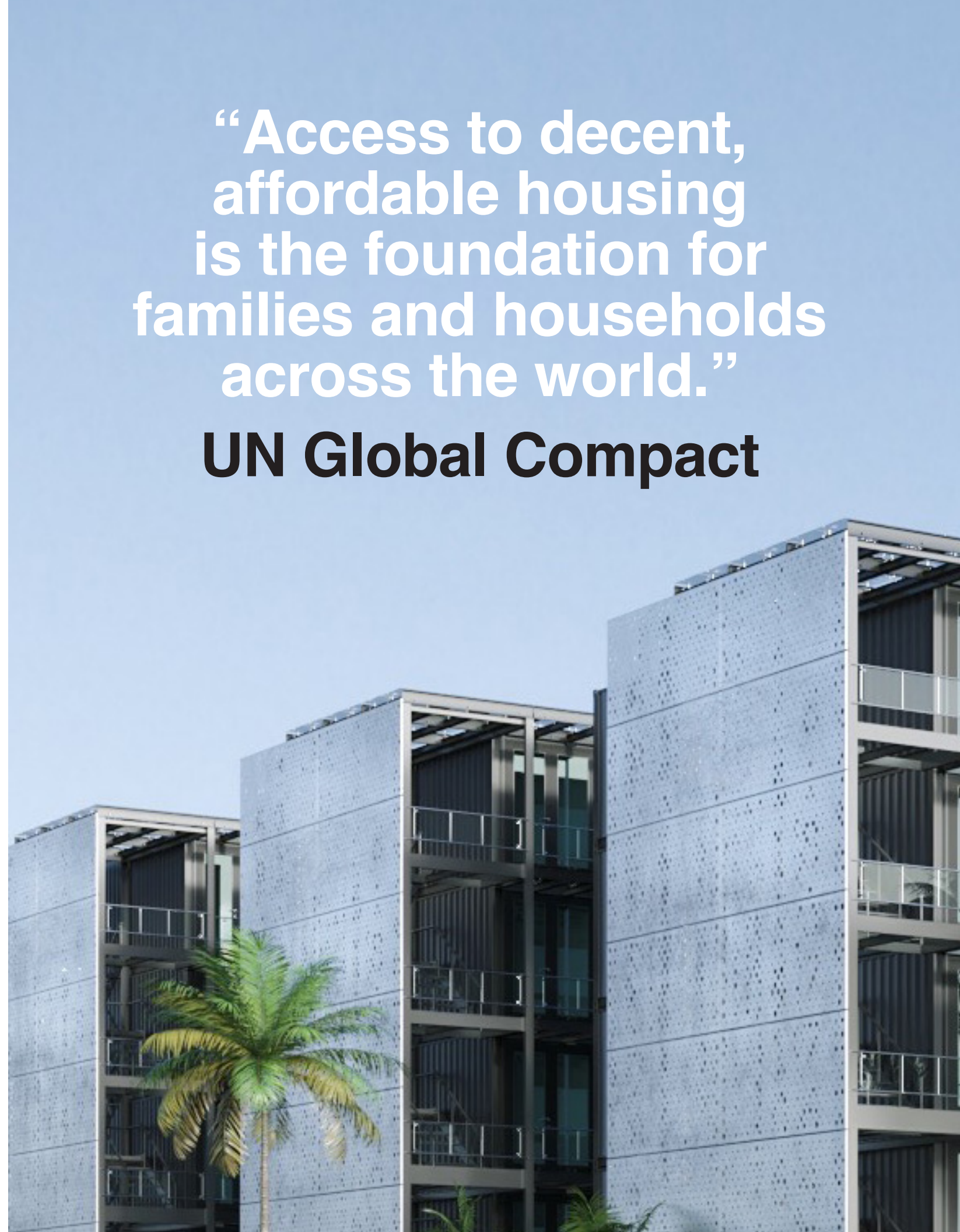

Mass Produced Housing



Global Deployment

Highly mobile – due to standardized sizes, shipping containers can be shipped almost anywhere via truck, train or boat. CSC certified containers allows us to ship globally. Shipped into any major port across the globe.

Disaster Relief

Long Term Rebuilding

International relief must not only address the direct effects of disasters, but also the long-term rebuilding efforts that will mitigate the communities from falling into other disasters like disorder, conflict and violence.

Rebuilding Communities Fast

Between 2000 and 2012, natural disasters caused \$1.7 trillion in damage and affected 2.9 billion people worldwide. During that time, 1.1 million people were killed as a result of natural disasters. With this much destruction, humanitarian disaster relief is crucial for helping communities rebuild.

Supportive Housing

Composed of stackable, prefabricated modules, our system is meant to offer a cost-effective, high-quality solution to affordable and supportive housing. Our modules can be assembled in different configurations. Depending site conditions and locations a single dwellings can be made from 1 40' container or blocks of containers can rise up to 6+ storeys to create up to 300 one bedroom units on one acre.

Within the modules the containers are all identical. This allows our team to mass produce these units and save time and money in the design and permitting process. No matter the site, the same set of drawings applies and allows us to have our buildings pre-inspected prior to leaving the factory.

The system is particularly well suited for homeless shelters, affordable and supportive housing.





Benefits of Container Construction

**Factory
Built**

**Mass
Produced**

**Fraction
of the Cost
of Traditional
Buildings**

Modular

**Globally
Deployed**

**Construction
Time**

Containers

ADA

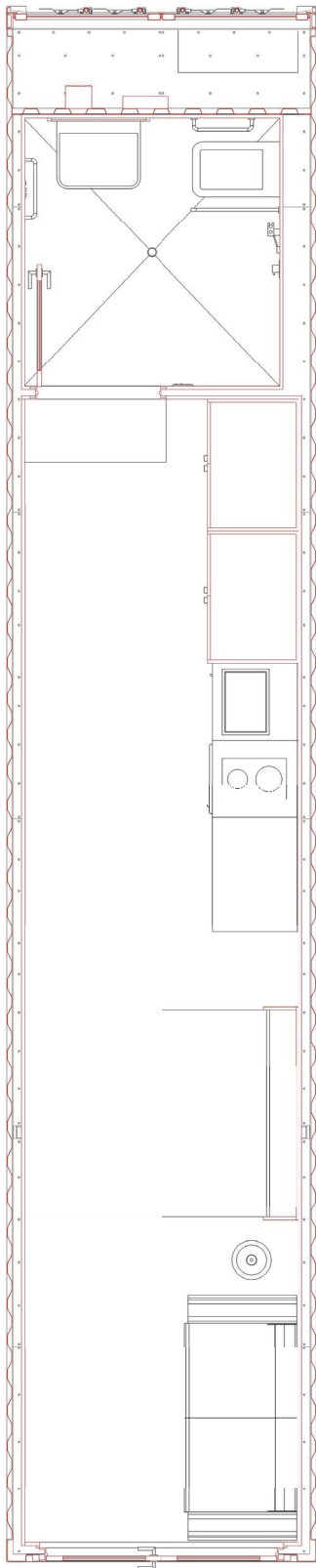

Standard

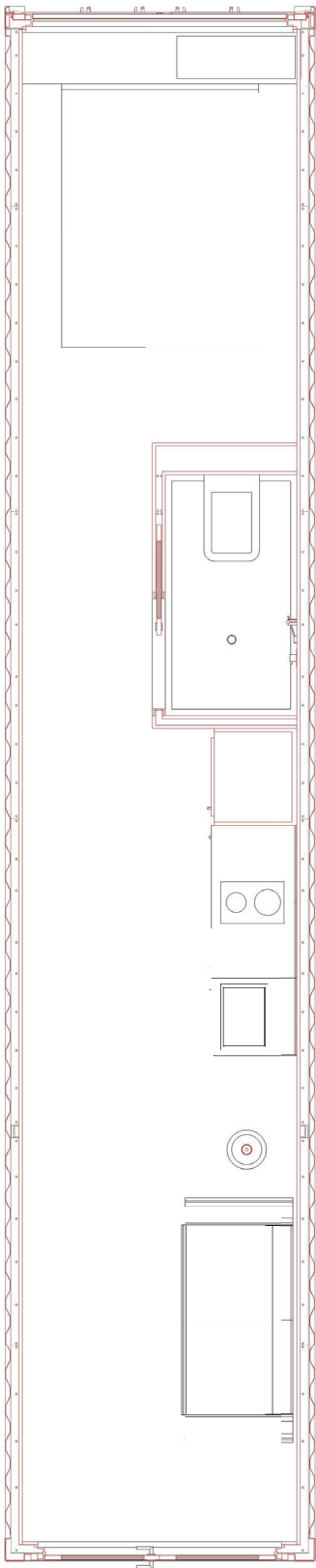



Technical Data

	20' Container		40' Container	
	IMPERIAL	METRIC	IMPERIAL	METRIC
External Dimensions				
Lenght	19' 10.5"	6.058 m	40' 0"	12.192 m
Width	8' 0"	2.438 m	8' 0"	2.438 m
Height	8' 6"	2.591 m	8' 6"	2.591 m
Interior Dimensions				
Lenght	19' 3"	5.867 m	39' 5" 45' 64"	12.192 m
Width	7' 8" 19' 32"	2.352 m	7' 8" 19' 32"	2.352 m
Height	7' 9" 57' 64"	2.385 m	7' 9" 57'64"	2.385 m
Door Aperture				
Width	7' 8.125"	2.343 m	7' 8.125"	2.343 m
Height	7' 5.75"	2.280 m	7' 5.75"	2.280 m
Internal Volume	1,169 ft³	33.1 m³	2,385 ft³	67.5 m³
Maximum Gross Weight	66,139 lb	30,400 kg	66,139 lb	30,400 kg
Empty Weight	4,850 lb	2,200 kg	8,380 lb	3,800 kg
Net Load	61,289 lb	28,200 kg	57,759 lb	26,200 kg

Manufacturing Process

Why do we build from scratch?

Giant strives to create products that are efficient, affordable and go beyond structural engineers' requirements. As a result, we've discovered that to build at scale is to build from scratch, especially for large commercial and residential developments. This allows us to build the modules faster and stronger resulting in a unit that does not require additional reinforcements while maintaining structural integrity. We are the only factory in North America that can offer this on a custom fabricated shipping container shell.

Steel Studs

Steel studs are used on all projects. All studs are rivetted to ensure a high quality, strong structure. For heavy-duty or mobile units we utilize 2x2 steel angles for a stronger and more resistant unit.

Steel Structure Welding

Thick HSS tubing is used along top and bottom rails to ensure strength and to allow for 40' openings with no vertical posts.

Spray-Foam Insulation

We utilize 2lbs closed cell spray foam for a R6.5 rating for every inch.

Glazing

Windows are manufactured in China using German hardware in order to meet all certification standards.

Custom Window Covers

Window covers are made custom for each unit and are easily bolted on and off for protection during transport.

Doors

Customers can choose from single or double door options, as well as custom glass doors. All doors are built from scratch for each project's requirements.

Flooring

Cross members are welded in, as per container standards. Customers have a variety of flooring options, from aluminum to eco friendly bamboo, etc.

Painting

The container is then primed and painted with Valspar Water based marine grade paint. Two coats of each ensure this paint will last.

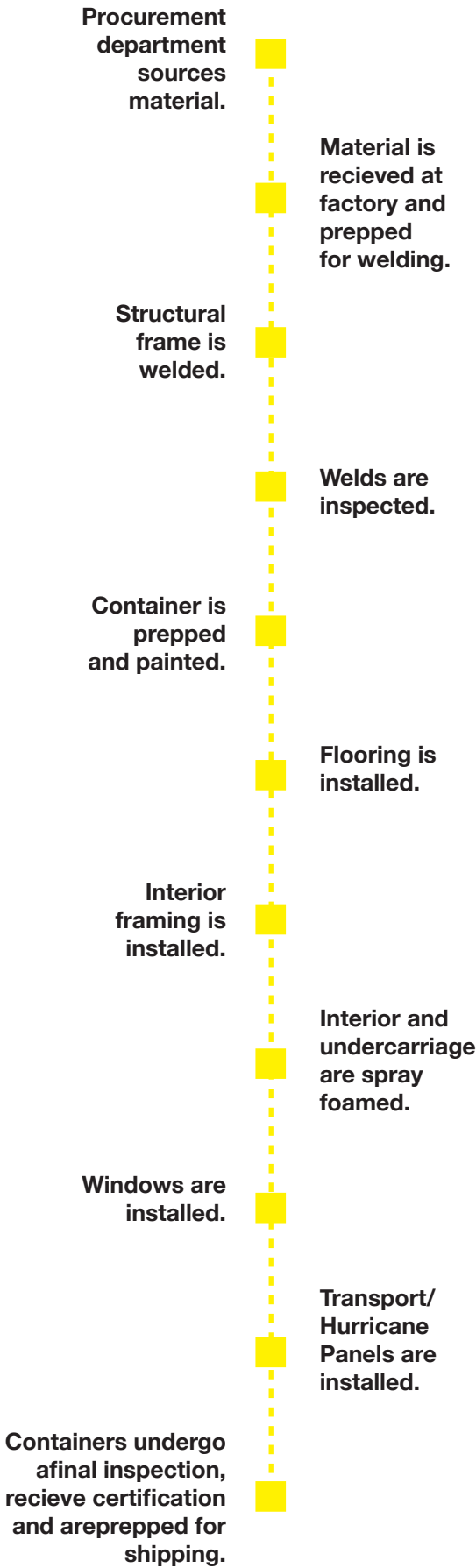



Toronto
Los Angeles
Miami
Brooklyn
Shanghai

1-888-97-GIANT
@giantcontainers
GiantContainers.com